

TROUBLESHOOTING

PROBLEM	CAUSE AND REMEDY
The appliance does not switch on	There is no voltage. Check the main switch and/or the electrical connections.
The impeller does not turn	Check that its movement is not slowed down.



DISMANTLING AND RECYCLING

The product has been designed and constructed using high-quality materials and components that can be recycled or re-utilised.

If a crossed-out wheeled bin is illustrated on a product, this means that the product satisfies the requirements of the 2012/19/EU European Directive.

Make inquiries about the disposal collection methods of electrical and electronic products in force in the zone in which the product must be disposed of.

Conform to the local norms regarding the disposal of waste materials and do not dispose of old products in normal domestic waste material. A correct dismantling and disposal of products helps to prevent environmental pollution and possible injury to health.

Abusive disposal of the product by the user implies the application of administrative fines foreseen by the norms in force.

In case of incorrect or doubtful translation, only the Italian text applies (Translation of the original instructions).

FLUX Series



INSTRUCTION MANUAL

Cod. 00431.05



The equipment must be installed only by a specialised technician!

Read and apply that referred to the following pages before carrying out the installation.
Keep this manual in a safe place.

Dear Customer,

the product you have purchased is a centrifugal duct fans range, designed to overcome the pressure and resistance caused by long length of ducting, suitable for wall, panel and ceiling installation. To ensure optimum operation and guarantee a long life, read this manual carefully that explains how to effectuate a correct installation and to use and maintain the product properly. Following all the instructions ensures reliability and long life, both mechanically and electrically.

The manufacturer declines any responsibility for damages caused to persons or things deriving from the lack of observance of the following described instructions.

The product is constructed using state of the art technology and respects the standards in force regarding electrical equipment. It conforms with the EMC 2014/30/EU European Directive regarding radio interference suppression and electro-magnetic compatibility.

Installation and usage instructions



WARNING: Serious injury or death can be caused if these instructions are not applied!

- Do not use this product for uses that are different from those for which it has been designed.
- After removing the product from its packaging ensure that it is complete and undamaged; if in doubt, immediately contact a qualified electrician.
- Do not leave parts of the packaging within reach of children or incompetent persons. To dispose of the packaging and the appliance at the end of its useful life refer to the recycling norms in force in your country.
- Immediately contact a qualified person (authorised dealer or the manufacturer) if the product is dropped or knocked to check its correct functioning.
- Do not touch the appliance with wet or humid parts of the body (e.g., hands or feet).
- This appliance can be used by children aged from 8 years and above and persons with reduced physical, sensory or mental capabilities or lack of experience and knowledge if they have been given supervision or instruction concerning use of the appliance in a safe way and understand the hazards involved. Children shall not play with the appliance. Cleaning and user maintenance shall not be made by children without supervision.
- The means of disconnection from the supply mains must have a contact separation in all poles and must provide full disconnection under overvoltage category III conditions.
- If there is a combustible-fed device (water heater, gas boiler, etc. of the sealed chamber type) in the room where the product is to be installed check that the re-circulation of air is sufficient to ensure a good combustion for the correct functioning of these devices, precautions must be taken to avoid the back-flow of gases into the room from the open flue of gas or other fuel-burning appliances.
- To avoid the risk of fire do not use the product in the presence of inflammable substances and vapours, such as alcohol, insecticides, petrol, etc.
- The product can be connected to the supply mains only if the voltage and the frequency of the supply mains correspond to those written in the rating label.
- In the case of malfunction, anomaly or any type of fault disconnect the appliance from the electrical main supply and contact a qualified person. Use only original spare parts for repairs.
- The electrical system to which the appliance is connected must conform with the local norms in force regarding electrical systems.
- The appliance must not be used to activate water heaters, room heaters, etc.
- It is forbidden for the appliance to discharge air into hot air ducts used for the evacuation of fumes coming from the combustion of stoves or other combustion devices. It must discharge directly outside the building.



Maico Italia S.p.A.
Via Maestri del Lavoro, 12 - 25017 Lonato del Garda (Bs) **ITALIA**
Tel. (+39) 030 9913575 - Fax (+39) 030 9913766 e-mail: info@maico-italia.it www.elicent.it

WARNING: Damage can be caused to the device if the following instructions are not applied!

- Do not use the product at environmental temperatures more than 40°C.
- Do not leave the appliance exposed to atmospheric agents (rain, sun, snow, etc.). The possible applications of this product are illustrated in this manual.
- Do not immerse the appliance or parts of it in water or any other liquids.
- When cleaning or carrying out ordinary maintenance, check the integrity of the appliance.
- The flow of air or fumes that is conveyed by the appliance must be clean and free of greasy elements, soot, chemical/corrosive agents and inflammable or explosive mixtures.
- Do not obstruct the air inlet and outlet of the appliance in any way whatsoever. When using air ducting make sure that the ducting is not blocked.
- For optimum operation, ensure that the product is installed at a minimum height of 2.30 m above the ground.
- For an optimum functioning of the appliance, it is necessary to ensure an adequate re-circulation of air in the room.

Consult the local norms with regards to this.

Only for model Flux 250: A THE PRODUCT IS EQUIPPED WITH A MANUAL RESET PROTECTION DEVICE WHICH WILL TRIGGER IN THE CASE OF A FAULT.

YOU MUST ELIMINATE THE FAULT BEFORE CARRYING OUT MANUAL RESET.

ANY FURTHER RESETTING WILL ONLY BE POSSIBLE BY DISCONNECTING THE EQUIPMENT FROM THE POWER SUPPLY.

MODE OF INSTALLATION

- Please refer to Fig. 1 for installation instructions.
- The type of cable to be used is shown in Fig. 2.
- To replace the outlet connecting piece in model 250, refer to Fig. 5.

OPERATION

Standard version: this fan is operated by means of a control switch (see wiring diagram Fig.4a).

Pull-cord version: operated by pulling the cord. Pulling the cord again turns the fan off (see wiring diagram Fig. 4a).

Timer version:

Please refer to Fig.3a for adjustment of the timer. Turn the trimmer towards the "+" sign for a longer over-run period and for a shorter over-run period, turn towards the "-" sign.

These models can either be wired via a LIGHT SWITCH (Fig. 4c), or via a REMOTE (ILLUMINATED) SWITCH (Fig. 4b). In both instances the fans will start to operate when the light or remote switch is switched on, and will continue to run via the timer for the pre-set overrun time after the switch is off.

Version with humidistat and timer:

Please refer to Fig. 3b for adjusting the humidistat and/or timer (adjust the timer as described above); to adjust the sensitivity of the humidistat turn the trimmer marked "Hy%" towards the higher number to make it less sensitive to the level of humidity.

This fan incorporates an adjustable humidistat which is sensitive to the level of moisture (relative humidity) in the air. The fan operates automatically when the humidity reaches the pre-set level. The fan will continue to operate until it has removed the moisture from the air. The fan can also be operated by the remote switch, light switch or pull cord independently of how much moisture there is in the air (Fig. 4b and 4c).

When the switch is off, the fan will continue to run until any humidity in the air has fallen beneath the pre-set level, and the timer has completed the over-run period. (**Note:** if you wish to run the fan **only** via the humidistat, connect terminals "L" and "N" only - Fig. 4b).

Version with 2 speed (24h) for adaptable models only:

The fan runs continuously at the min. speed. The fan is boosted to the maximum speed by means of either a LIGHT SWITCH (see wiring diagram Fig.4c), or REMOTE (ILLUMINATED) SWITCH (see wiring diagram Fig. 4b), or PULL CORD (see wiring diagram Fig. 4b, connecting terminals "L" and "N" only). When the switch is off, the fan will continue to run at the maximum speed until the timer has completed the over-run period, and then revert to the minimum speed.

Version with 2 speed (24h) and humidistat/timer for adaptable models only (Fig. 4b-c):

See above description. The fan is also boosted to the maximum speed when the humidity reaches the pre-set level. When it has fallen beneath this level, and the timer has completed the over-run period, the fan will continue to run at the minimum speed.

Version with humidistat/timer, pull cord, 1 or 2 speed:

If you wish to run the fan only via the humidistat, connect terminals "L" and "N" only (Fig. 4b-c).

The fan operates automatically when the humidity reaches the pre-set level (at the minimum speed in case of 2 speed version) and continues to run until any humidity in the air has fallen beneath the pre-set level and the timer has completed the over-run period. The fan, when in stand-by or at the minimum speed for the 2 speed version, can be activated by pulling the cord (in case of a 2 speed version the fan is boosted to the maximum speed): the neon indicator shows

when the fan is manually activated or in override mode. Pulling the cord again, the neon light is off and, after the overrun timer period, the fan reverts to the automatic operation by the humidistat to its stand-by position or, in case of a 2 speed version at the minimum speed.

WARNING: If the level of Relative Humidity in the room is superior to the pre-set one, the automatic running has the priority on the manual one. Therefore, it will not be possible to switch off the fan through the switch.

FIG.1

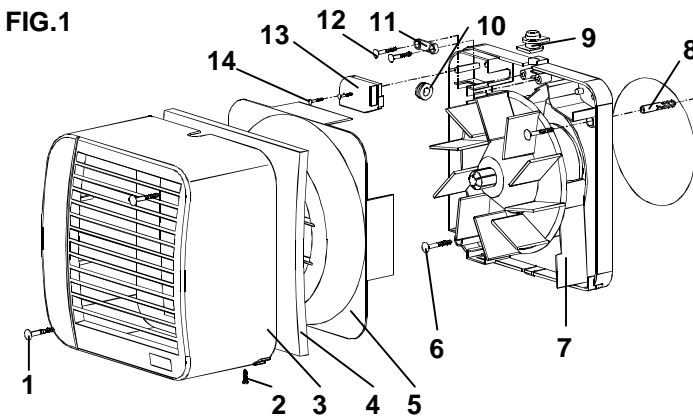

LEGEND

1. FRONT FIXING SCREWS (MODEL 250)
2. FRONT FIXING SCREWS (MODEL 100)
3. FRONT COVER
4. FILTER
5. AIR CONVEYOR
6. WALL FIXING SCREWS
7. MOTOR SUPPORT
8. FISCHER
9. CABLE GROMMET
10. CABLE GROMMET
11. CABLE CLAMP
12. CABLE CLAMP SCREWS
13. TERMINAL COVER
14. FIXING SCREWS FOR TERMINAL COVER

FIG.2

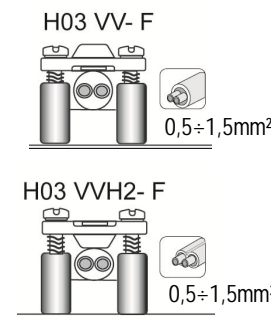

FIG.3a

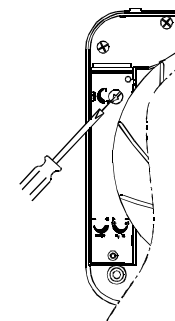

FIG.3b

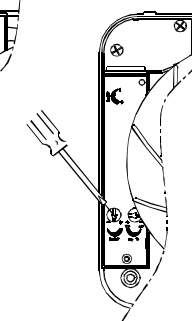

FIG.5

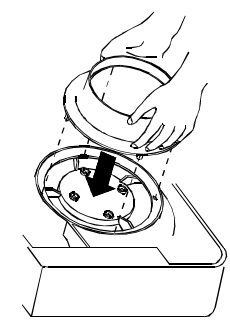

FIG.4a

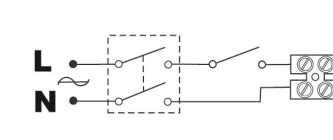

FIG.4b

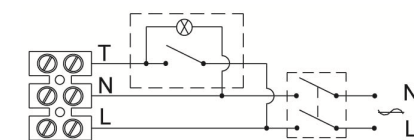
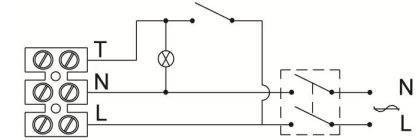
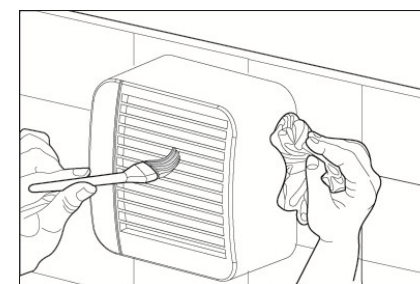
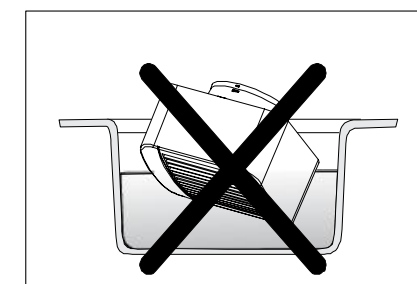
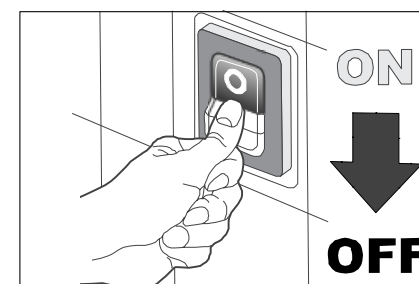

FIG.4c



ORDINARY MAINTENANCE AND CLEANING



MAINTENANCE AND CLEANING CARRIED OUT BY A QUALIFIED PERSON !!!!

- Remove the front cover (Fig. 1 - nr.3).
- Clean the front cover with a mild detergent or water.
- Remove the air conveyor Fig.1 - nr. 5).
- Wash the filter (Fig.1 - nr. 4) with a mild detergent and be sure it is dry before re-assembling.
- The motor-fan assembly should be cleaned with a dry brush or dry cloth.
- Electrical parts cannot be cleaned.
- Ensure that the motor-fan does not come into contact with any kind of liquid or solvent.